

105.2m

STAMFORD STREET WEST

Hugh Mason House

FLEET STREET

PARK PARADE

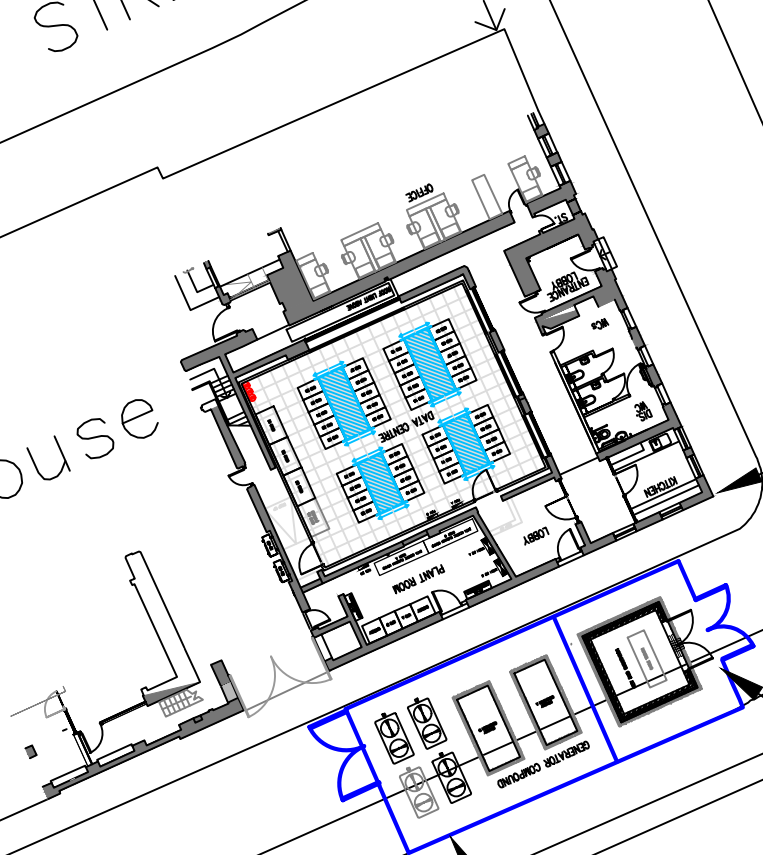

PROPOSED SERVICE YARD
 GENERATORS/SUBSTATIONS
 ARE INDICATIVE ONLY +
 WILL BE SUBJECT TO
 SUBSEQUENT APPLICATION.



OS-Related to match Topographical
 Survey Co-Ordinates by 0.1deg.

This map is based upon Ordnance Survey
 material with the permission of Ordnance
 Survey on behalf of the Controller of Her
 Majesty's Stationery Office © Crown copyright.
 Unauthorised reproduction infringes Crown
 copyright and may lead to prosecution or civil
 proceedings. Tameside MBC Licence No
 LA100022697, 2005.

NOTES:

This drawing is to be read in conjunction with all related drawings.
 Do not scale from this drawing.
 All dimensions must be checked and verified on site before
 commencing any work.
 The originator should be notified immediately of any discrepancy.
 This drawing is copyright and remains the property of Tameside
 Council.

**SUBSTATION & DATA ROOM GENERATOR COMPOND AND EQUIPMENT
 TO BE SURROUNDED IN A 'DELTAWING-100' ROBUST STEEL LOUVRED
 METAL FENCING SYSTEM- 2.4m high. Frame to be hidden internally behind the
 panels, so not visible externally**

Title
**PROPOSED CHANGE OF USE
 FROM HIGHWAY TO SERVICE YARD.
 FLEET STREET, ASHTON-U-LYNE.**

Scale	Drawn C.BIRD	Checked SO	Scheme ID -
NTS @ A3	Date FEB 18	Date FEB 18	Drawing Status -